

[WWW.CBRE.COM/PNCC](http://WWW.CBRE.COM/PNCC)

FOR LEASE

# PNC CENTER

101-115 W. WASHINGTON STREET, INDIANAPOLIS, INDIANA 46204



**CBRE**





PNC Center is an outstanding Class A office building located in the 'center of it all' in Downtown Indianapolis. PNC Center provides first class amenities to its tenants including the new Nexus at PNC featuring a tenant lounge, kitchen, Farmer's Fridge healthy vending, shoe shine, lockers, pick-up dry cleaning and Amazon Drop Box.

## FEATURES

- ◆ New Nexus at PNC now open
- ◆ Attached to 2,500 covered parking spaces
- ◆ On-site full time leasing and management personnel
- ◆ Green Roof Plaza — first of its kind in Indianapolis
- ◆ Efficient floor layouts with great views of Indy
- ◆ State-of-the-art facilities including: Access control, Elevators, Fire and life safety, Mechanical equipment, Restrooms, Security
- ◆ Full Floors Available, Up to 80,000 SF
- ◆ Year-round covered connectivity to Circle Centre Mall, Lucas Oil Stadium, the Convention Center, 52 restaurants and 9 hotels
- ◆ Three restaurants, one bank, coffee shop and more
- ◆ New amenities added — Farmers Fridge Vending and Amazon Drop Box



# PNC CENTER

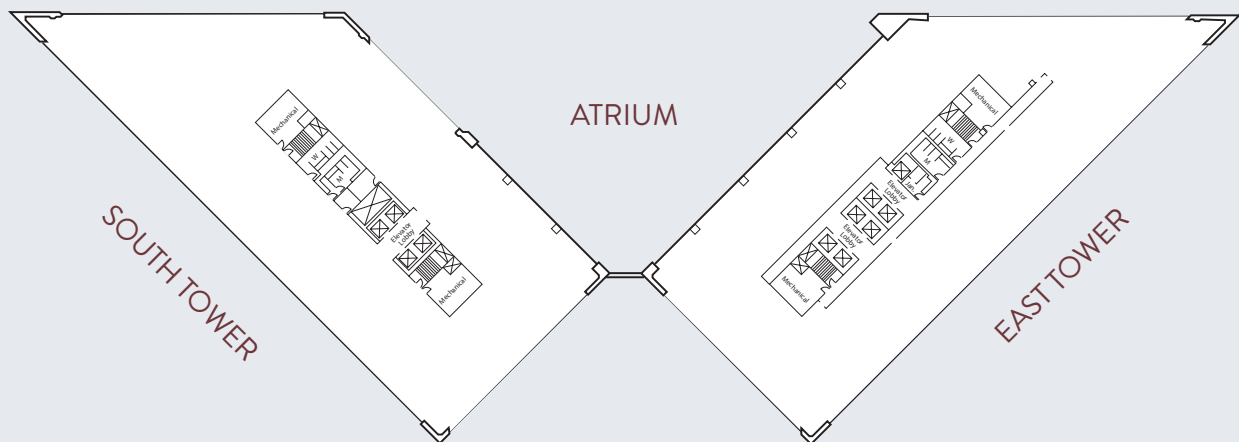
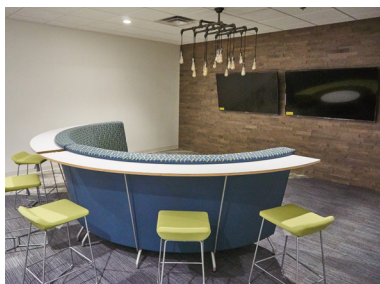

**FLOOR PLAN**



FOR LEASE

# PNC CENTER



[WWW.CBRE.COM/PNCC](http://WWW.CBRE.COM/PNCC)



101-115 W. WASHINGTON STREET  
INDIANAPOLIS, INDIANA 46204

## FOR MORE INFORMATION, PLEASE CONTACT:

John Vandenberg  
Senior Vice President  
+1 317 269 1046

[john.vandenberg@cbre.com](mailto:john.vandenberg@cbre.com)

Beth Sallee  
Senior Associate  
+1 317 269 1126

[beth.sallee@cbre.com](mailto:beth.sallee@cbre.com)



# CBRE

© 2020 CBRE, Inc. All rights reserved. This information has been obtained from sources believed reliable, but has not been verified for accuracy or completeness. You should conduct a careful, independent investigation of the property and verify all information. Any reliance on this information is solely at your own risk. CBRE and the CBRE logo are service marks of CBRE, Inc. All other marks displayed on this document are the property of their respective owners. Photos herein are the property of their respective owners. Use of these images without the express written consent of the owner is prohibited.